

Extension to Meekatharra Water Reserve
 File A 16130—Whereas it is enacted by section 9 (1) (b) of the Country Areas Water Supply Act 1947, that the Governor may, by Order in Council, alter and extend the boundaries of a water reserve, now, therefore His Excellency the Lieutenant-Governor and Administrator, acting by and with the advice and consent of the Executive Council, does hereby extend the boundaries of the Meekatharra Water Reserve as delineated and shown with symbolised boundary **-----** on Water Authority of Western Australia Plan BT86 depicted below.

G. PEARCE, Clerk of the Council.

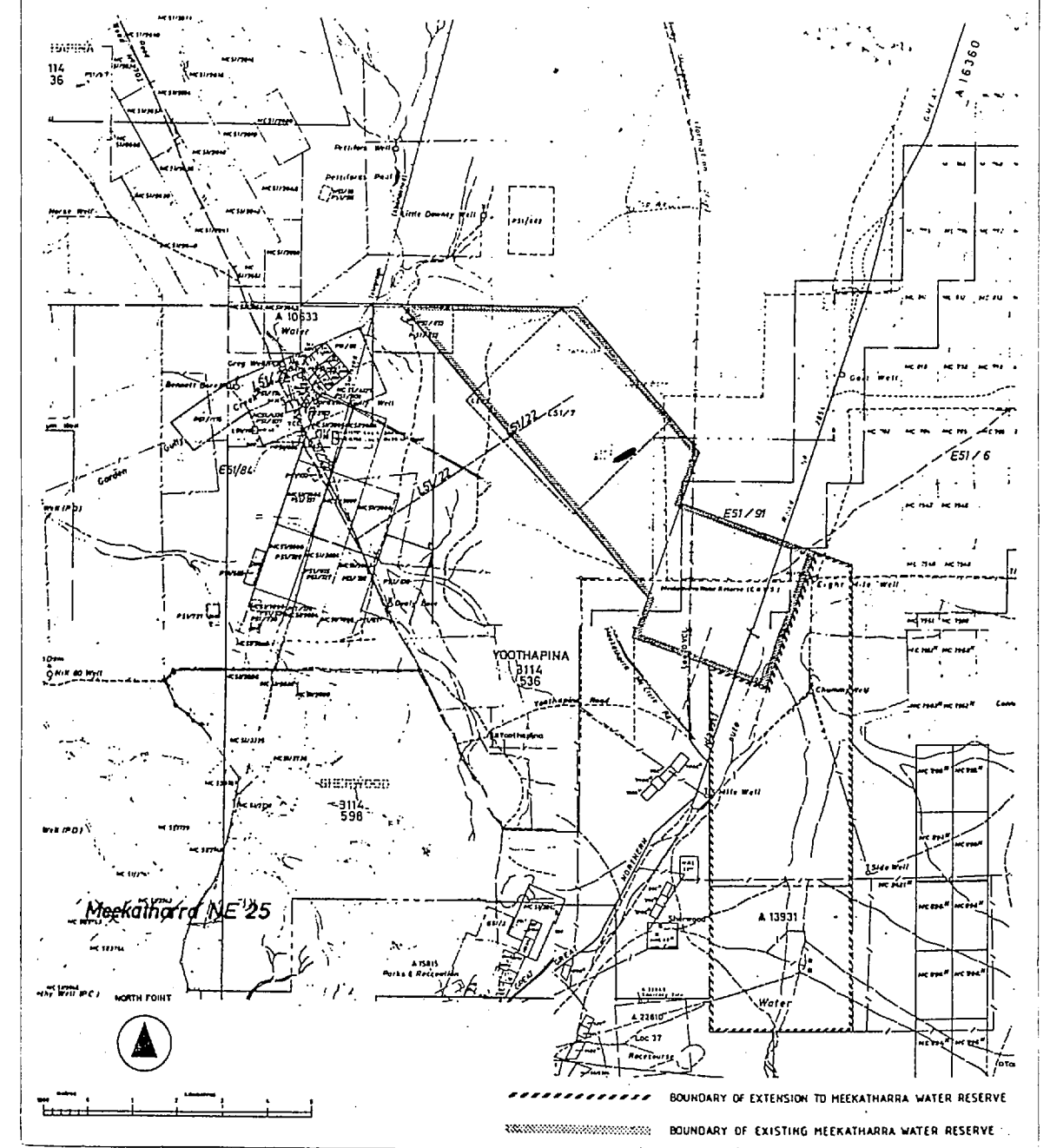

----- BOUNDARY OF EXTENSION TO MEEKATHARRA WATER RESERVE
 _____ BOUNDARY OF EXISTING MEEKATHARRA WATER RESERVE

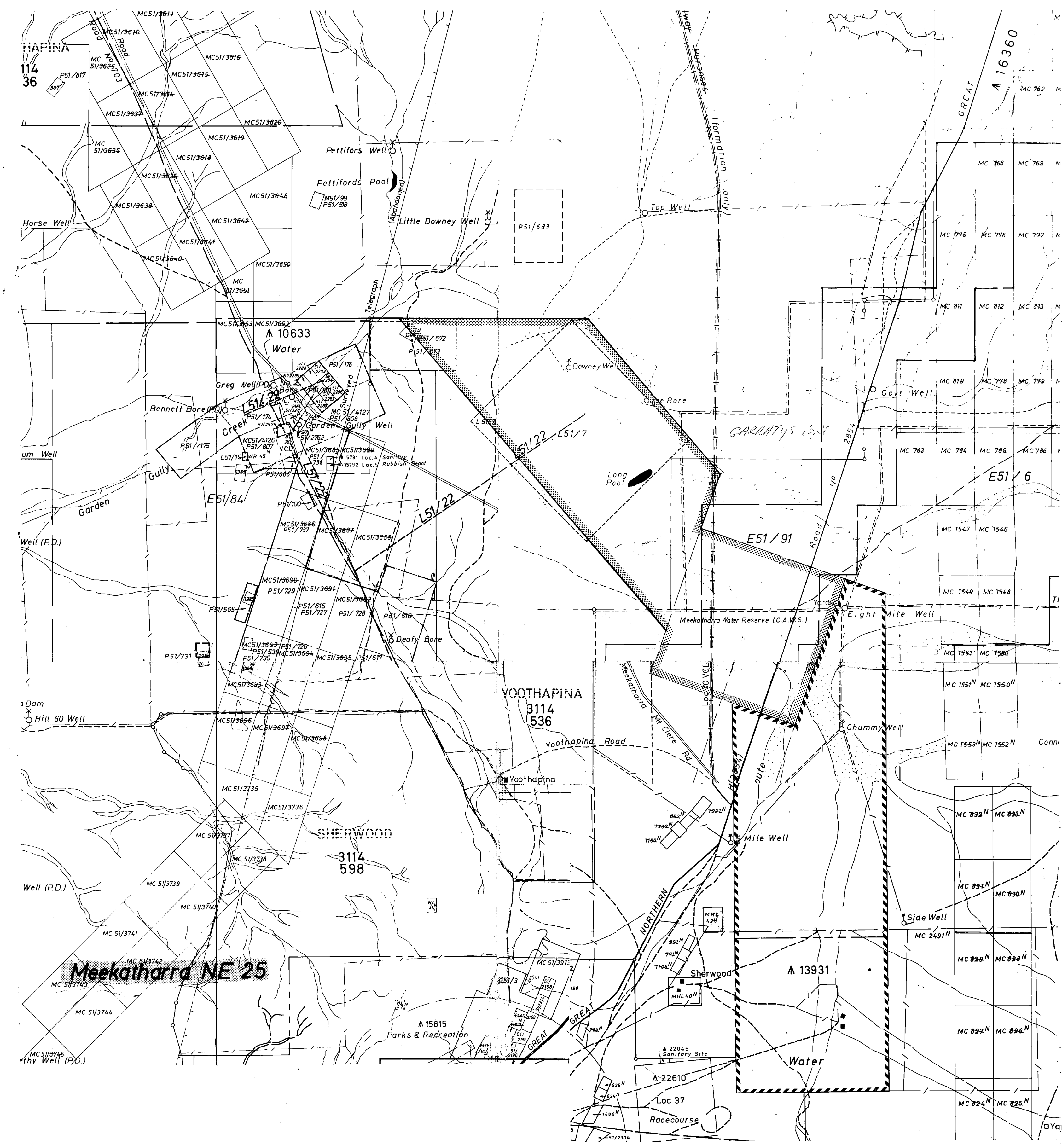
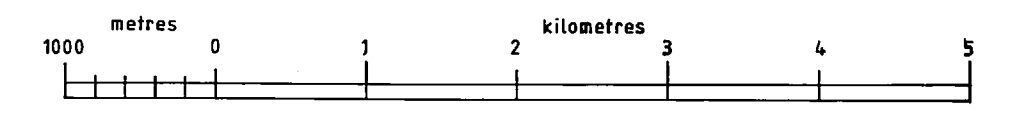

G. Pearce
 CLERK OF THE EXECUTIVE COUNCIL
 21 DEC 1989

ISSUE		DATE	GRID	REVISION	DRN	APPD	SURVEY BOOKS	DATUM	DES. REF	DES.	CHD.	NORTH POINT	RECOMMENDED	<p>Water Authority of Western Australia</p>	COUNTRY AREAS WATER SUPPLY ACT, 1947 EXTENSION TO MEEKATHARRA WATER RESERVE PLAN TO ACCOMPANY ORDER IN COUNCIL			ORIGINAL SHEET SIZE		
810													<p>MANAGING DIRECTOR</p>		<p>DIRECTOR, WATER RESOURCES</p>	FILE	PROJECT	PLAN	ISSUE	
															A16130			BT86	8-2-90	A1